

CLUFIX-STUD™ on demand

Your data :

Company : _____ Contact person name : _____
 Address : _____ Postal Code : _____ City : _____
 _____ Country : _____
 _____ Phone : _____ Fax : _____
 e-mail : _____ Web Site : _____
 Industry : _____

1 CLUFIX-STUD™ MATERIAL

- STEEL STAINLESS STEEL 316L STAINLESS STEEL ALUMINIUM OTHER _____

2 HEAD

- FLANGE

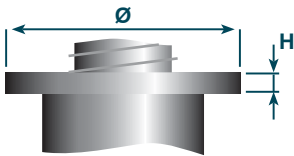

- H Standard
 Special : _____ mm
 Ø Standard
 Special : _____ mm
other options : with lugs
 with seal

- FLUSH



- COUNTERSUNK

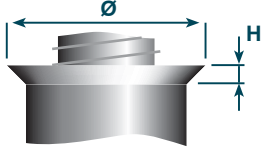

- H Standard
 Special _____ mm
 Ø Standard
 Special _____ mm
other options : with lugs

- OTHER

Various specifications :

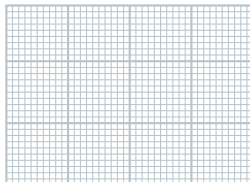

NOTES : _____

3 BODY

- ROUND



- HEXAGONAL



- KNURLED



4 APPLICATION

CHARACTERISTICS OF THE WORKPIECE RECEIVING CLUFIX-STUD™

Minimum thickness : _____ mm / Maximum : _____ mm Material : _____

Final product : _____

Space requirement: Ls _____ mm

Ls + S _____ mm

Lus _____ mm

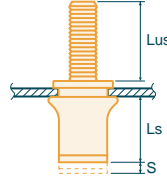

5 WORKPIECE HOLE DIAMETER

Standard as per La Clusienne

Other dimension : _____

6 THREADS

Ø M _____

Ø UNC _____

Ø UNF _____

standard pitch

fine pitch

other : _____

7 MECHANICAL REQUIREMENTS

Tensile force : _____ daN

Direct torque force : _____ Nm

Indirect torque force : _____ Nm

Other : _____

8 SEAL

IP code required : _____ Seal type required : _____

(IP codes and seal characteristics available in CLUFIX® technical data pages 16-17)

9 FINISH

Corrosion resistance required : Standard : _____

White rust : _____ h

Red rust : _____ h

Friction coefficient required : _____

Finish required : _____

10 VOLUMES

Batch quantity required : _____

Yearly quantity : _____

Application lifetime : _____

Forecast :

2nd year : _____ parts

3rd year : _____ parts